

## FDS Non-Metallic Series

### Fusible Safety Disconnect Switches

### 30, 60 & 100 Amp; NEMA 4X; 12

#### ORDERING INFORMATION





AMPERE RATING (GENERAL PURPOSE)	UL FUSE TYPE (NOT PROVIDED)	3 Ø HP RATINGS						CATALOG NO. *
		STANDARD			MAXIMUM *			
		240V	480V	600V	208/240V	480V	600V	
30A	J & CC+	3	5	7.5	7.5	15	20	<b>ME 30FDS2A</b>
60A	J				15	30	50	<b>ME 60FDS3A</b>
100A	J				30	60	75	<b>ME 100FDS3A</b>

\* Use CAT. NO. ME 30FDS2A-CC if CC fuse holder is required. Consult factory for delivery.

\* Requires fuses with time-delay characteristics if starting current of motor is more than the standard horsepower rating.

#### Compliances & Performance:

-  Standard 98
-  to CSA 22.2 No. 4-M89, Enclosed Switch
- Environmental: NEMA Type 4X; 12
- Flame Rating: UL 94-5VA and VO
- Continuous Operating Temperature -40°C to +60°C
- UV Resistance: Enclosure and Handle Materials are UV Stabilized
- UL Endurance Test: 6,000 Electrical Cycles / 10,000 Mechanical Cycles
- UL Minimum Short Circuit Rating: 100,000 RMS Symmetrical Amperes with Type J Fuses

#### AUXILIARY CONTACTS

AMP	TYPE	CATALOG NO.
30	1 N/O or 1 N/C	<b>ME 30FDAUX</b>
60	1 N/O and 1 N/C	<b>ME 60FDAUX</b>
100	1 N/O and 1 N/C	<b>ME 100FDAUX</b>

#### REPLACEMENT SWITCHES

DESCRIPTION	CATALOG NO.
30 Amp	<b>ME 30XFDSJ</b>
60 Amp	<b>ME 60XFDSJ</b>
100 Amp	<b>ME 100XFDSJ</b>

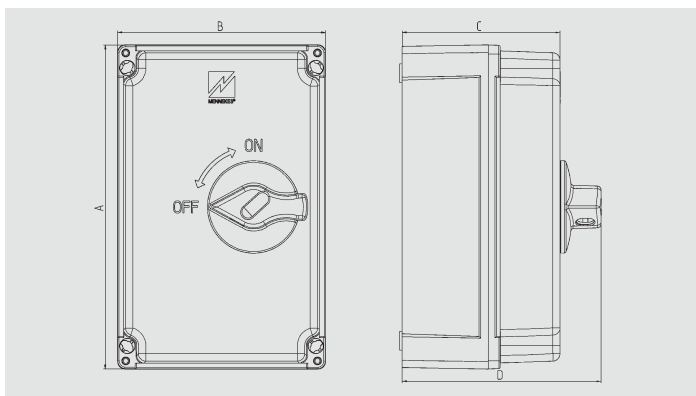

#### Approximate Dimensions (in inches)

	30 AMP	60 AMP	100 AMP
A	10	10	14
B	6	8	12
C	5	7	6
D	6	9	8